

Notes:

- installation instructions in [TDS](#)
- apply joint seal in opening, flush with wall on 2 sides
- **other pipe dØ + s1** (thickness) are allowed within range and same pipe material
- EI for flexible walls ≥100mm is also applicable for **rigid walls** ≥100mm
- angle: perpendicular + all angles between 90° and 45°

principle detail

Firetect®

tested property
test method
service no.

fire resistance
EN 1366-3
20-12

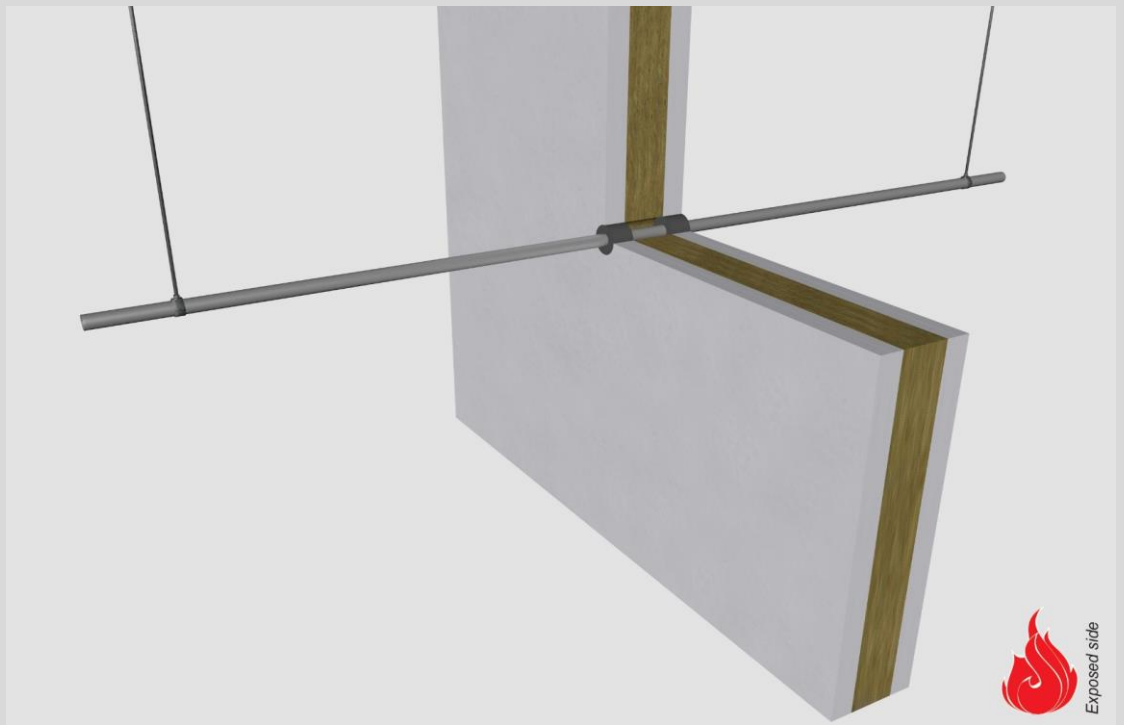

steel pipes

Graphite sealant

service type ¹⁾		pipe insulation		EI	constructive element ²⁾	Firetect joint seal		application	backing required	max. opening in construction	pipe end configuration	max. angle
dØ (mm)	s1 (mm)	PA coating DFT 0,8mm	PA sealer 3mm			width	depth					
Ø8	1,0	PA coating	200 LI	EI 90	flexible walls ≥ 100 mm	-	-	2 sides	-	8 mm	C/U + U/C + C/C	perpendicular + all angles between 90° and 45°
Ø12	1,0	PA coating	300 LI	EI 90	flexible walls ≥ 100 mm	10 mm	25 mm	2 sides	-	32 mm	C/U + U/C + C/C	
		PA coating	200 LI	EI 120	rigid walls ≥ 150 mm	10 mm	25 mm	2 sides	-	32 mm	C/U + U/C + C/C	
Ø15	1,0	-	-	EI 60	flexible walls ≥ 100 mm	10 mm	25 mm	2 sides	-	35 mm	C/U + U/C + C/C	
		PA coating	200 LI	EI 120	flexible walls ≥ 100 mm	10 mm	25 mm	2 sides	-	35 mm	C/U + U/C + C/C	
		PA coating	200 LI	EI 120	rigid walls ≥ 150 mm	14 mm	25 mm	2 sides	-	44 mm	C/U + U/C + C/C	
Ø22	1,1	PA coating	300 LI	EI 60	flexible walls ≥ 100 mm	10 mm	25 mm	2 sides	-	42 mm	C/U + U/C + C/C	
		PA coating	200 LI	EI 120	rigid walls ≥ 150 mm	10 mm	25 mm	2 sides	-	44 mm	C/U + U/C + C/C	
Ø26,9	2,9	PA coating	300 LI	EI 120	flexible walls ≥ 100 mm	10 mm	25 mm	2 sides	-	47 mm	C/U + U/C + C/C	
		PA coating	200 LI	EI 120	rigid walls ≥ 150 mm	10 mm	25 mm	2 sides	-	50 mm	C/U + U/C + C/C	
Ø28	1,2	PA coating	300 LI	EI 60	flexible walls ≥ 100 mm	10 mm	25 mm	2 sides	-	48 mm	C/U + U/C + C/C	
		PA coating	200 LI	EI 90	rigid walls ≥ 150 mm	10 mm	25 mm	2 sides	-	50 mm	C/U + U/C + C/C	
42,2	3,25	-	-	EI 60	flexible walls ≥ 100 mm	10 mm	25 mm	2 sides	-	62 mm	C/U + U/C + C/C	
		PA coating	300 LI	EI 90	flexible walls ≥ 100 mm	10 mm	25 mm	2 sides	-	62 mm	C/U + U/C + C/C	
		PA sealer	300 LI	EI 60	flexible walls ≥ 100 mm	10 mm	25 mm	2 sides	-	61 mm	C/U + U/C + C/C	
60,3	3,0	PA coating	200 LI	EI 90	rigid walls ≥ 150 mm	10 mm	25 mm	2 sides	-	82 mm	C/U + U/C + C/C	
max.												
Ø219,1	4,5	PA sealer	300 LI	EI 60	flexible walls ≥ 100 mm	10 mm	25 mm	2 sides	-	245 mm	C/U + U/C + C/C	

¹⁾ Penetration services must be supported; support distance ≤ 500mm.

²⁾ Constructive element must be classified acc. EN 13501-2 for the required fire resistance period. EI for flexible walls ≥100mm is also applicable for rigid walls ≥100mm!