

**Notes:**

- installation instructions in [TDS](#)
- apply joint seal in opening, flush with wall/floor on 2 sides
- **other pipe dØ + s1** (thickness) are allowed within range and same pipe material
- EI for flexible walls ≥100mm is also applicable for **rigid walls** ≥100mm
- angle: perpendicular + all angles between 90° and 45°

principle detail

Firetect®

tested property  
test method  
service no.

fire resistance  
EN 1366-3  
10-50s

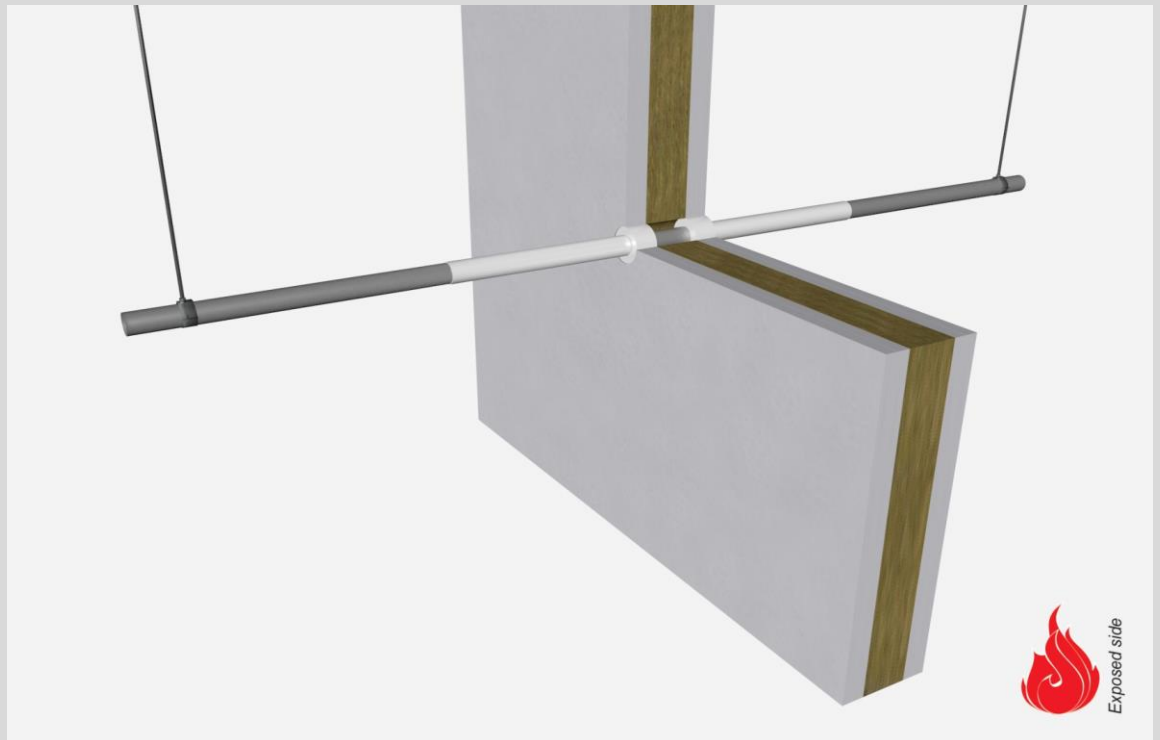

**steel pipes**

**Acrylic sealant**

service type <sup>1)</sup>		pipe insulation	EI	constructive element <sup>2)</sup>	Firetect joint seal		application	backing	max. opening	pipe end	max. angle
dØ (mm)	s1 (mm)	PA coating DFT 0,8mm			width	depth	1 or 2 sides	required	in construction	configuration	
<b>up to</b>											
Ø12	1,0	-	EI 120	rigid walls ≥ 150 mm	10 mm	25 mm	2 sides	-	32 mm	C/U	perpendicular + all angles between 90° and 45°
		-	EI 120	rigid floors ≥ 150 mm	10 mm	25 mm	2 sides	-	32 mm	C/U	
		PA coating	200 LI	EI 90	flexible walls ≥ 100 mm	10 mm	25 mm	2 sides	-	32 mm	
Ø15	1,0	-	EI 120	rigid walls ≥ 150 mm	15 mm	25 mm	2 sides	-	44 mm	C/U	
		-	EI 120	rigid floors ≥ 150 mm	15 mm	25 mm	2 sides	-	44 mm	C/U	
		PA coating	200 LI	EI 60	flexible walls ≥ 100 mm	10 mm	25 mm	2 sides	-	35 mm	
Ø22	1,1	-	EI 60	rigid walls ≥ 150 mm	10 mm	25 mm	2 sides	-	44 mm	C/U	
		-	EI 60	rigid floors ≥ 150 mm	10 mm	25 mm	2 sides	-	44 mm	C/U	
		PA coating	200 LI	EI 60	flexible walls ≥ 100 mm	10 mm	25 mm	2 sides	-	42 mm	
Ø26,9	2,9	-	EI 120	rigid walls ≥ 150 mm	11 mm	25 mm	2 sides	-	50 mm	C/U	
		-	EI 120	rigid floors ≥ 150 mm	11 mm	25 mm	2 sides	-	50 mm	C/U	
Ø28	1,2	-	EI 60	rigid walls ≥ 150 mm	11 mm	25 mm	2 sides	-	50 mm	C/U	
		-	EI 60	rigid floors ≥ 150 mm	11 mm	25 mm	2 sides	-	50 mm	C/U	
		max. 2x bundled	PA coating	200 LI	EI 180	rigid walls ≥ 150 mm	smokeseal	2 sides	-	70 mm	C/U
		max. 2x bundled	PA coating	200 LI	EI 180	rigid floors ≥ 150 mm	smokeseal	2 sides	-	70 mm	C/U
Ø42,2	3,25	PA coating	200 LI	EI 180	rigid walls ≥ 150 mm	smokeseal	2 sides	-	50 mm	C/U	
		PA coating	200 LI	EI 180	rigid floors ≥ 150 mm	smokeseal	2 sides	-	50 mm	C/U	
<b>max.</b>											
60,3	3,0	-	EI 120	rigid walls ≥ 150 mm	10 mm	25 mm	2 sides	-	82 mm	C/U	
		-	EI 120	rigid floors ≥ 150 mm	10 mm	25 mm	2 sides	-	82 mm	C/U	

<sup>1)</sup> Penetration services must be supported; support distance ≤ 500mm (wall) or ≤ 400mm (floor).

<sup>2)</sup> Constructive element must be classified acc. EN 13501-2 for the required fire resistance period.