

Notes:

- installation instructions in [TDS](#)
- apply joint seal in opening, flush with wall/floor on 2 sides
- **other pipe dØ + s1** (thickness) are allowed within range and same pipe material
- EI for flexible walls ≥100mm is also applicable for **rigid walls** ≥100mm
- angle: perpendicular + all angles between 90° and 45°

principle detail

Firetect®

tested property
test method
service no.

fire resistance
EN 1366-3
10-50

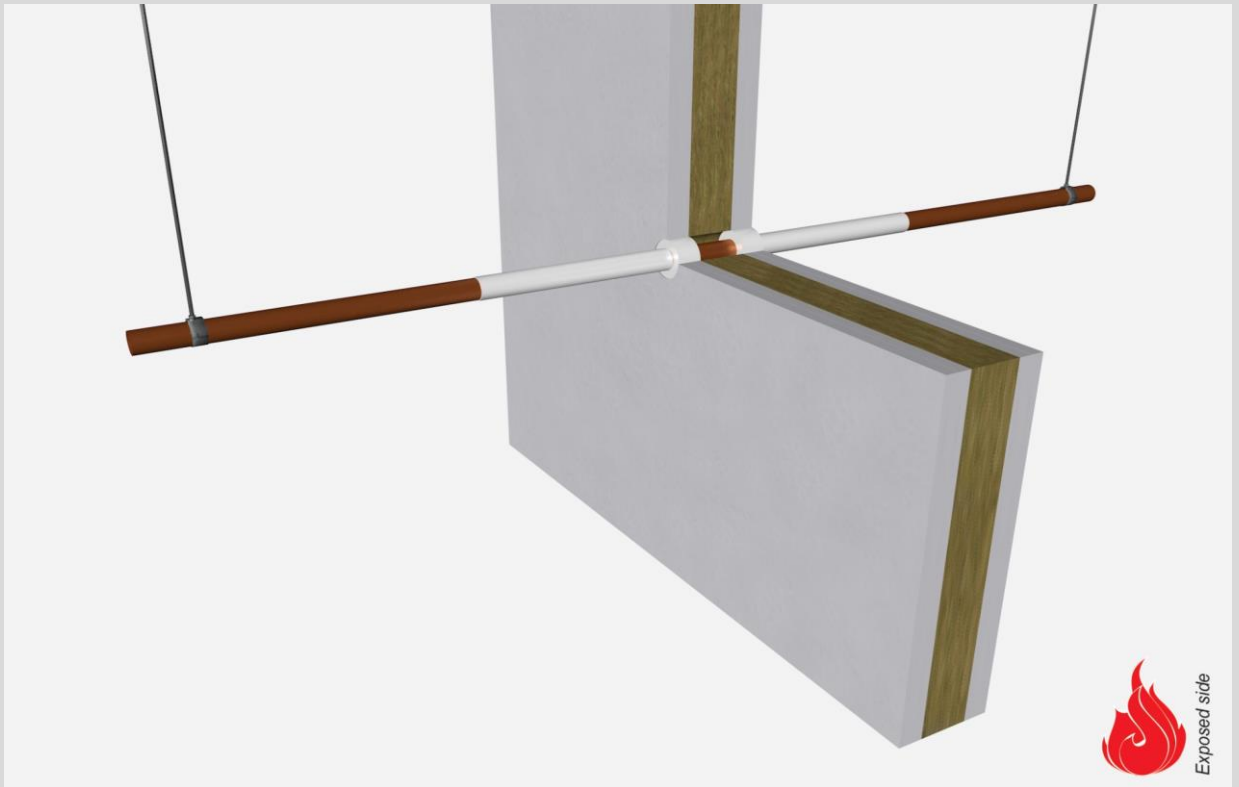

copper pipes

Acrylic sealant

service type ¹⁾		pipe insulation	EI	constructive element ²⁾	Firetect joint seal	application	backing	max. opening	pipe end	max. angle
dØ (mm)	s1 (mm)	PA coating DFT 0,8mm			width	depth	1 or 2 sides	in construction	configuration	
up to										
Ø8	1,0	-	EI 180	rigid walls ≥ 150 mm	8 mm bead		1 side	8 mm	C/U + U/C + C/C	perpendicular + all angles between 90° and 45°
Ø8	1,0	-	EI 180	rigid floors ≥ 150 mm	8 mm bead		1 side	8 mm	C/U + U/C + C/C	
Ø8	1,0	PA coating	200 LI EI 90	flexible walls ≥ 100 mm	-		2 sides	8 mm	C/U + U/C + C/C	
Ø12	1,0	-	EI 120	rigid walls ≥ 150 mm	10 mm	25 mm	2 sides	32 mm	C/U + U/C + C/C	
		-	EI 120	rigid floors ≥ 150 mm	10 mm	25 mm	2 sides	32 mm	C/U + U/C + C/C	
		PA coating	200 LI EI 90	flexible walls ≥ 100 mm	10 mm	25 mm	2 sides	32 mm	C/U + U/C + C/C	
Ø15	1,0	-	EI 120	rigid walls ≥ 150 mm	15 mm	25 mm	2 sides	44 mm	C/U + U/C + C/C	
		-	EI 120	rigid floors ≥ 150 mm	15 mm	25 mm	2 sides	44 mm	C/U + U/C + C/C	
		PA coating	200 LI EI 60	flexible walls ≥ 100 mm	10 mm	25 mm	2 sides	35 mm	C/U + U/C + C/C	
Ø22	1,1	-	EI 60	rigid walls ≥ 150 mm	10 mm	25 mm	2 sides	44 mm	C/U + U/C + C/C	
		-	EI 60	rigid floors ≥ 150 mm	10 mm	25 mm	2 sides	44 mm	C/U + U/C + C/C	
		PA coating	200 LI EI 60	flexible walls ≥ 100 mm	10 mm	25 mm	2 sides	42 mm	C/U + U/C + C/C	
max.										
Ø28	1,2	-	EI 60	rigid walls ≥ 150 mm	11 mm	25 mm	2 sides	50 mm	C/U + U/C + C/C	
		-	EI 60	rigid floors ≥ 150 mm	11 mm	25 mm	2 sides	50 mm	C/U + U/C + C/C	

¹⁾ Penetration services must be supported; support distance ≤ 500mm (wall) or ≤ 400mm (floor).

²⁾ Constructive element must be classified acc. EN 13501-2 for the required fire resistance period. EI for flexible walls ≥100mm is also applicable for **rigid walls** ≥100mm!