

Notes:

- installation instructions in [TDS](#)
- apply joint seal in opening, flush with wall/floor on 2 sides
- **other pipe dØ + s1** (thickness) are allowed within range and same pipe material
- EI for flexible walls ≥100mm is also applicable for **rigid walls** ≥100mm
- angle: perpendicular + all angles between 90° and 45°

principle detail

Firetect®

tested property
test method
service no.

fire resistance
EN 1366-3
0064

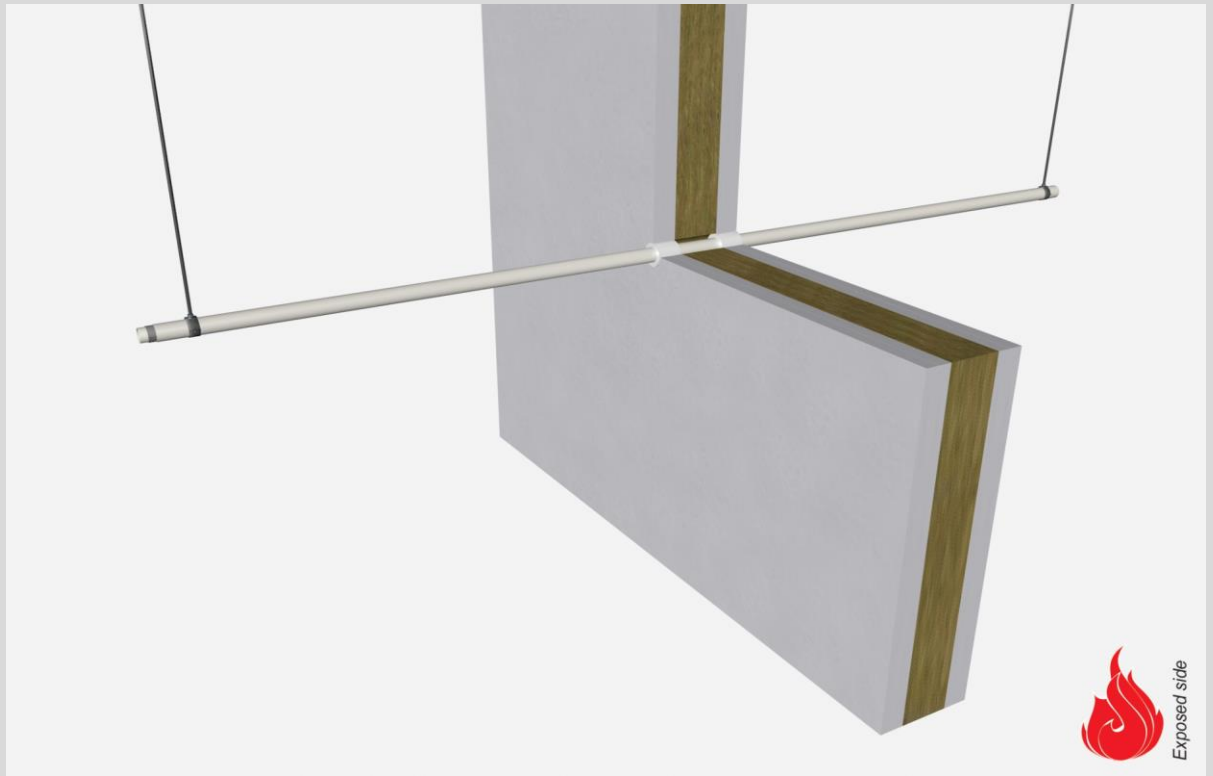

aluPE-X pipes

Acrylic sealant

service type ¹⁾		pipe insulation		EI	constructive element ²⁾	Firetect joint seal		application	backing required	max. opening in construction	pipe end configuration	max. angle
dØ (mm)	s1 (mm)	min. 60 kg/m ³ eg Armaflex				width	depth					
up to												
Ø16	2,0	-	-	EI 120	flexible walls ≥ 100 mm	5 mm	25 mm	2 sides	-	26mm	U/C + C/C	perpendicular + all angles between 90° and 45°
		synth. rubber 13mm	700 LS + LI + CS + CI	EI 120	rigid walls ≥ 150 mm	10 mm	25 mm	2 sides	-	62mm	U/C + C/C	
		13mm	700 LS + LI + CS + CI	EI 120	rigid floors ≥ 150 mm	10 mm	25 mm	2 sides	-	62 mm	U/C + C/C	
Ø25	2,5	-	-	EI 120	flexible walls ≥ 100 mm	10 mm	25 mm	2 sides	-	45 mm	U/C + C/C	
		synth. rubber 13mm	700 LS + LI + CS + CI	EI 120	rigid walls ≥ 150 mm	10 mm	25 mm	2 sides	-	71 mm	U/C + C/C	
		13mm	700 LS + LI + CS + CI	EI 60	rigid walls ≥ 100 mm	10 mm	25 mm	2 sides	-	200x1000 mm	U/C + C/C	
					in FR mortar	10 mm	25 mm	2 sides	-	200x1000 mm	U/C + C/C	
					rigid floors ≥ 150 mm	10 mm	25 mm	2 sides	-	71 mm	U/C + C/C	
Ø63	6.0	synth. rubber 13mm	700 LS + LI + CS + CI	EI 120	rigid walls ≥ 150 mm	10 mm	25 mm	2 sides	-	109 mm	U/C + C/C	
		13mm	700 LS + LI + CS + CI	EI 60	rigid walls ≥ 100 mm	10 mm	25 mm	2 sides	-	200x1000 mm	U/C + C/C	
		13mm	700 LS + LI + CS + CI	EI 120	rigid floors ≥ 150 mm	10 mm	25 mm	2 sides	-	109 mm	U/C + C/C	
max.												
Ø75	7,5	synth. rubber 13mm	700 LS + LI + CS + CI	EI 120	rigid walls ≥ 150 mm	10 mm	25 mm	2 sides	-	121 mm	U/C + C/C	
		13mm	700 LS + LI + CS + CI	EI 60	rigid walls ≥ 100 mm	10 mm	25 mm	2 sides	-	200x1000 mm	U/C + C/C	
		13mm	700 LS + LI + CS + CI	EI 120	rigid floors ≥ 150 mm	10 mm	25 mm	2 sides	-	121 mm	U/C + C/C	

¹⁾ Penetration services must be supported; support distance ≤ 500mm (wall) or ≤ 400mm (floor).

²⁾ Constructive element must be classified acc. EN 13501-2 for the required fire resistance period. EI for flexible walls ≥100mm is also applicable for rigid walls ≥100mm!