

tested property  
 test method  
 service no. **0321**  
 tested property  
 test method

fire resistance  
 EN 1366-2  
 smoke resistance  
 EN 1634-3

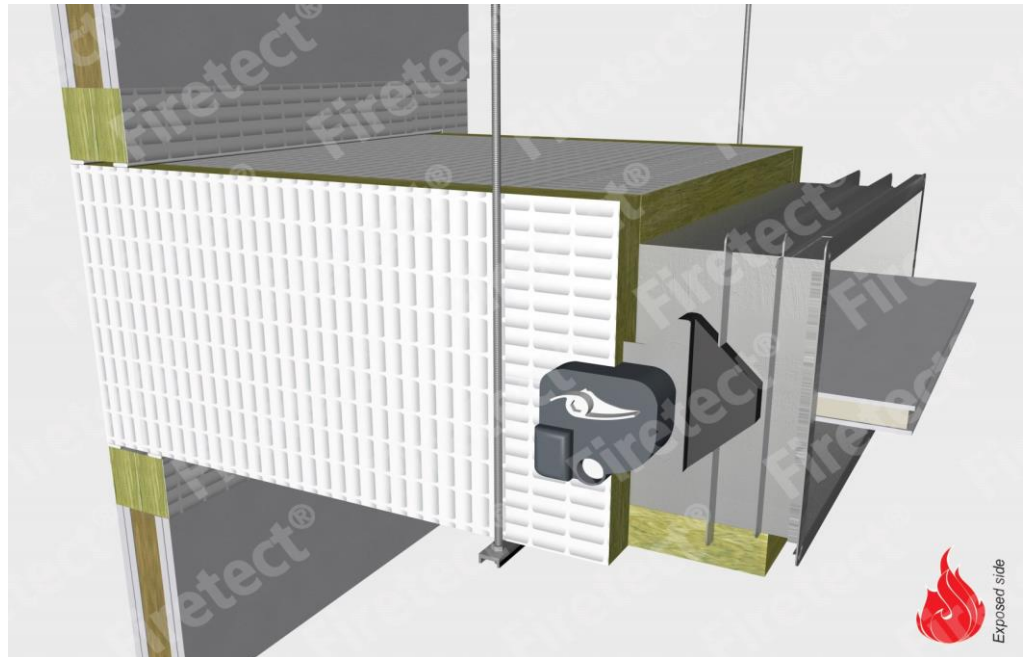

## fire dampers

fire damper specs <sup>1)</sup>	EI	constructive element <sup>2)</sup>	PA board	PA coating	application	max. opening in construction	finish required
			Firetect board seal type 2S 50 mm	Firetect coat seal DFT 0,8mm			
rectangular, max. 600 x 300 mm service: steel damper, supported to floor upgrade acc. EN 1366-2	EI 60	flexible walls ≥ 100 mm	cladding: 1 layer opening: 2 strips	-	1 or 2 sides 1 side	900 x 596 mm	seal adjacent joints with Firetect Acrylic
rectangular, max. 600 x 300 mm service: steel damper, supported to floor installation acc. EN 1366-3	EI 90	flexible walls ≥ 100 mm	opening: 2 strips	-	1 side	900 x 596 mm	seal adjacent joints with Firetect Acrylic
circular *, max. Ø 125 mm service: spiral pipe installation acc. EN 1366-3	EI 120	flexible walls ≥ 100 mm	-	200 LI	2 sides	130 mm	apply joint bead Firetect Acrylic
circular *, max. Ø 125 mm service: spiral pipe installation acc. EN 1366-3	EI 120	flexible ceilings ≥ 150 mm	-	200 LI	1 side	130 mm	apply joint bead Firetect Acrylic
circular *, max. Ø 125 mm service: spiral pipe installation acc. EN 1366-3	EI 120	rigid floors ≥ 150 mm	-	200 LI	1 side	130 mm	apply joint bead Firetect Acrylic

\* tested with + without valve

in PA board 2S 50 mm

<sup>1)</sup> Penetration services must be supported; always install services acc. manufacturer's instructions.

<sup>2)</sup> Constructive element must be classified acc. EN 13501-2 for the required fire resistance period. EI for flexible walls ≥100mm is also applicable for rigid walls ≥100mm!